

LAND-MARK SURVEYING

Mark L. Miritz

Wisconsin Registered Land Surveyor S-2582

N9330 Knuteson Drive
Whitewater, WI 53190
Phone: (262) 495-3284
FAX : (262) 495-8421
LAND-MARKSURVEYING.COM

PLAT OF SURVEY

LOTS 11343 THRU 11347, BLOCK 204,
LAKE COMO BEACH, A SUBDIVISION
LOCATED IN TOWN 2 NORTH, RANGE
17 EAST, GENEVA TOWNSHIP,
WALWORTH COUNTY, WISCONSIN.

ORDERED BY:

SCHAUDER BUILDING, INC.
4115 U.S. HIGHWAY 51 NORTH
JANESVILLE, WI 53545-9674

OWNERS: JOHN J. BOUCK

PATRICIA N. BOUCK
7612 WEST 93RD STREET
BRIDGEVIEW, IL 60455

NOTE:

NO VISIBLE UTILITIES ON THIS LOT. A SIGN AT
THE NORTHWEST CORNER INDICATED A GAS LINE.
DIGGERS HOT LINE COULD BE CALLED FOR ACTUAL
LOCATION

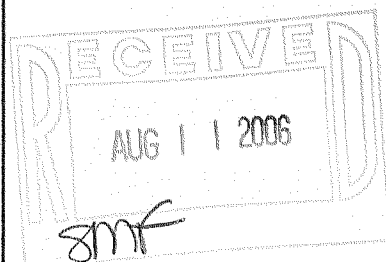
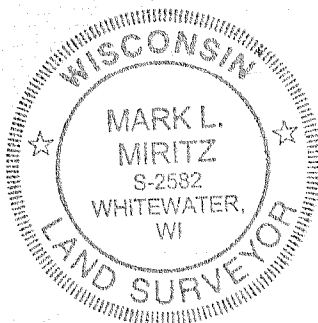

HEMLOCK DRIVE

(40' wide)

(100')
N 89°57'42" W 99.79'

TAX NO. JLCB 02466

11345

LOT 11347

LOT 11346

EXISTING

FOUNDATION

LOT 11344

LOT 11343

LOT 11342

APRICOT ROAD

(40' wide)

NORTH 100.14'
(100')

9,976 SQ. FT. TOTAL

GRAVEL DRIVE ENCROACHES 0.4'

GRAVEL DRIVE

S 89°46'51" W 99.92'
(100')

LOT 11339

BLOCK 204

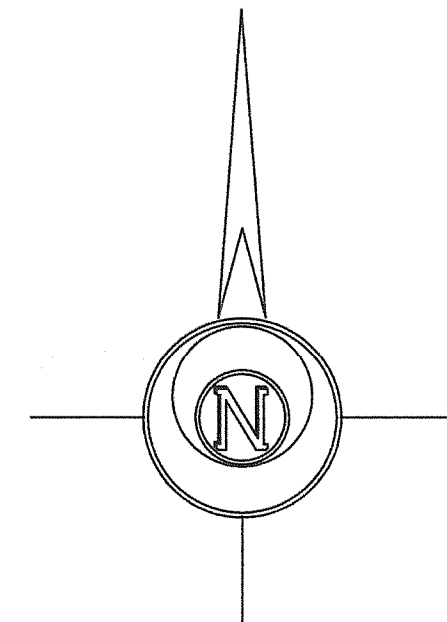

THE EAST LINE OF APRICOT RD WAS ASSUMED TO BEAR NORTH

LEGEND

- FOUND IRON PIPE
- FOUND IRON ROD
- FOUND COUNTY MONUMENT
- WOOD STAKE SET AT 10' OFFSET
- CHISEL CUT IN CONCRETE
- SET IRON ROD, 24" LONG, WEIGHING 1.5 LBS./LINEAL FT., 3/4" DIA.
- (x x) RECORDED AS DIMENSION
- EXISTING FENCE

SCALE: 1" = 20 FEET

"I hereby certify that the above described property has been surveyed by me or under my direction and that the above map is a true representation thereof and shows the size and location of the property, its exterior boundaries, the location of all visible structures and dimensions of all principal buildings thereon, boundary fences, apparent easements, roadways and visible encroachments, if any."

"This survey is made for the use of the present owners of the property, and also those who purchase, mortgage, or guarantee the title thereto within one year from date hereof."

MARK L. MIRITZ
WISCONSIN REGISTERED
LAND SURVEYOR S-2582

REVISED JULY 22, 2006 TO
SHOW FOUNDATION "AS BUILT" DATE: OCTOBER 19, 2005 JOB NO. 05.1009

JLCB - 2466

217-3295